



**SYNTHETIC SLING FITTINGS**

**WSL-320A**



- Suitable for use with 2-ply web slings and round slings.
  - Eye is designed with a wide beam surface, which eliminates bunching effects, reduces sling tendency to slide, and allows a better load distribution on internal fibers.
- All alloy construction.
- Each hook has a Product Identification Code (PIC) for material traceability along with a working load limit and the name Crosby forged into it.
- All hooks feature Crosby's patented QUIC-CHECK® indicators.
- Fatigue rated to 20,000 cycles at 1.5 times the Working Load Limit.
- Includes S-4320 latch.
- Crosby Sling Saver hardware meets the requirements for minimum stock diameter or thickness, and effective contact width shown in the Recommended Standards Specification for Synthetic Polyester Round Slings by the Web Sling & Tie Down Association (WSTDA-RS1).

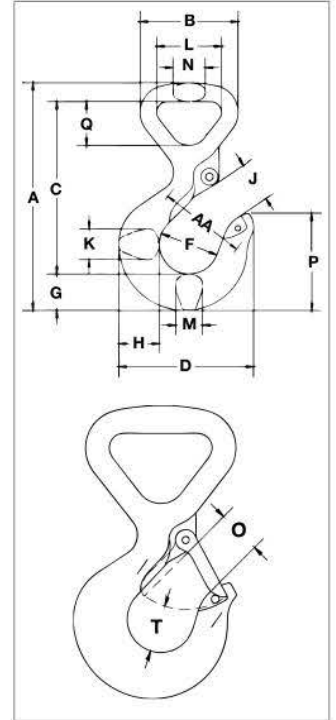

APPLICATION AND WARNING INFORMATION SECTION 17

9

**WSL-320A Synthetic Sling Hook**



Web Sling Eye Width (mm)	Round Sling Size (No.)	Working Load Limit (t)	WSL-320A with Latch	Weight Each (kg)	Hook I.D. Code	S-4320 Rep. Latch
25.0	1	1.5	1022706	.50	FA	1096374
50.0	2	3	1022717	1.30	HA	1096468
75.0	3	5	1022728	3.00	IA	1096515

**WSL-320A Synthetic Sling Hook**

Hook ID Code	Working Load Limit (t)	Dimensions (mm)																
		A	B	C	D	F	G	H	J	K	L	M	N	O	P	Q	T	AA
FA	1.5	133	57.5	101	79.0	35.1	21.3	23.9	23.6	18.0	38.1	16.0	19.1	23.1	57.0	25.7	24.9	51.0
HA	3	181	93.0	135	101	41.4	28.7	33.5	28.7	23.9	63.5	21.6	28.7	27.7	71.5	42.9	29.5	51.0
IA	5	237	130	179	122	51.0	36.6	41.4	37.3	33.3	95.5	28.7	41.4	34.5	89.0	66.0	38.9	63.5

Design factor of 5:1.  
Maximum Proof Load is 2.5 times the Working Load Limit.





S-287



- Special design of hook protects the synthetic sling when dropped or dragged.
- Uses same spool and cover as S-280 Web Connector.
  - Replacement Kit for Spool and Web Cover available.
  - No retaining pin to snag sling material.
- Forged alloy steel, Quenched & Tempered.
- Each Connector has a Product Identification Code (PIC) for material traceability along with a Working Load Limit and the name Crosby forged into it.
- Designed to reduce friction, abrasion, and fraying in choker area.
- Designed for use with Type III, (eye & eye).
- Crosby Sling Saver hardware meets the requirements for minimum stock diameter or thickness, and effective contact width shown in the Recommended Standards Specification for Synthetic Polyester Round Slings by the Web Sling & Tie Down Association (WSTDA-RS1).

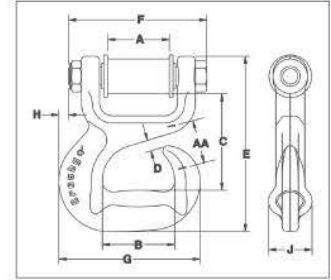

S-287 Sliding Choker Hook



Round Sling Size (No.)	Web Slings			Working Load Limit (t)	S-287 Stock No.	Weight Each (kg)	Dimensions (mm)									
	Webbing Width (mm)	Eye Width (mm)	Ply				A	B	C	D	E	F	G	H	J	AA
1 & 2	50	50	2	2.95	1021909	1.68	54.0	63.5	84.5	9.65	153	121	124	8.65	38.1	38.1
3	75	35	2	4.08	1021918	2.77	41.4	89.0	93.0	9.65	179	115	165	34.5	47.8	-

Design factor of 5:1.  
Maximum Proof Load is 2 times the Working Load Limit.